

# GFM-C Series

## GFM-1200C 2V1200Ah

GFM-C series VRLA battery uses latest AGM technology, high purity raw materials and many patented technologies that ensure its long floating and cycle life, it is applicable to less frequency of power failure, and shallow discharge of depth site. It is mainly used for indoor telecommunication base station.



### Benefits

- Long life according to EUROBAT Classification
- High discharge performance
- 99%+ gas recombination efficiency
- Maximum charge efficiency
- Low self-discharge rate
- Vertical installization

### Applications

- Telecommunications
- Power system
- UPS
- Emergency power

### Standards

- IEC 60896-21/22
- JIS C8704-1/2
- EUROBAT guide

### Drawing

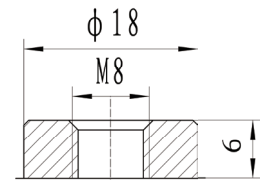
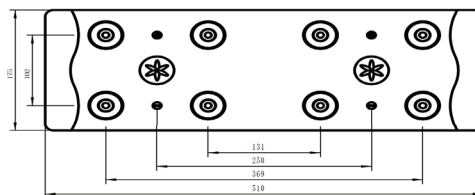
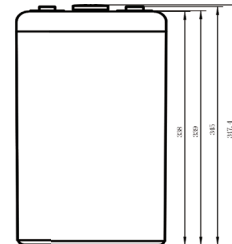
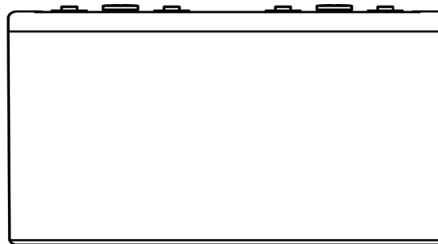

GFM-27

### Specifications

Battery Model	GFM-1200C			
Design Life (years, 25°C)	15			
Capacity (Ah, 25°C)	10HR (120A, 1.80V)	5HR (204A, 1.80V)	3HR (300A, 1.80V)	1HR (660A, 1.75V)
	1200	1020	900	660
Dimensions (mm)	Length	Width	Height	Total Height
	510	175	338	347
Approx. Weight (kg)	72.7			
Reference Internal Resistance (mΩ)	0.13( fully charged @ 25°C)			
Maximum Discharge Current (A/5 Sec.)	6000			
Self-Discharge (25°C)	≤ 1.5% per months			
Charge Voltage (V/cell, 25°C)	Cycle use		Float use	
	2.35 (-3.5mV/°C/cell), max charge current: 180A		2.25 (-3.5mV/°C/cell)	
Short Circuit Current (A)	9000			

## Discharge Data

Constant Current Discharge Data (25°C, A)															
End Voltage (V/cell)	min							h							
	5	10	15	20	30	40	50	1	1.5	2	3	5	8	10	24
1.60	2520	1947	1611	1387	1101	922	799	696	534	433	320	214	148	124	52.9
1.65	2291	1783	1489	1292	1038	878	766	684	521	426	315	211	147	123	52.6
1.70	2092	1636	1377	1204	979	835	734	664	508	418	311	209	145	122	52.3
1.75	1830	1507	1297	1147	946	813	717	660	500	411	306	206	144	121	51.9
1.80	1606	1395	1224	1094	910	786	695	629	486	401	300	204	142	120	51.5

Constant Power Discharge Data (25°C, W/cell)															
End Voltage (V/cell)	min							h							
	5	10	15	20	30	40	50	1	1.5	2	3	5	8	10	24
1.60	3672	3156	2661	2356	1854	1554	1375	1224	953	787	585	396	285	238	106
1.65	3373	2865	2438	2173	1722	1464	1307	1182	916	760	569	389	281	234	105
1.70	2977	2625	2268	2032	1607	1388	1237	1148	893	740	557	384	278	231	103
1.75	2668	2428	2114	1889	1507	1304	1181	1094	868	721	546	377	274	228	102
1.80	2452	2228	1937	1740	1413	1232	1138	1045	841	701	534	370	271	226	100

## Rack Layout

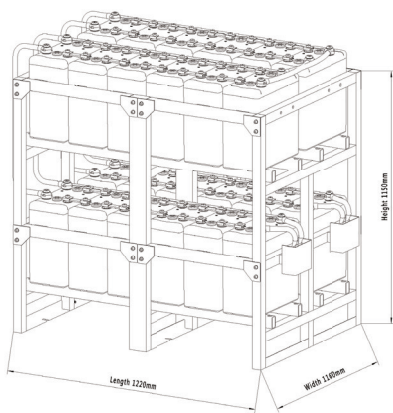

48V Standard Rack (Anti-seismic rack is optional)  
 Rack material: powder-coated steel  
 Height\*width: 2\*2  
 Ref. GFM-1200C Rack (approx. weight: 1822kg)

## Performance Curve

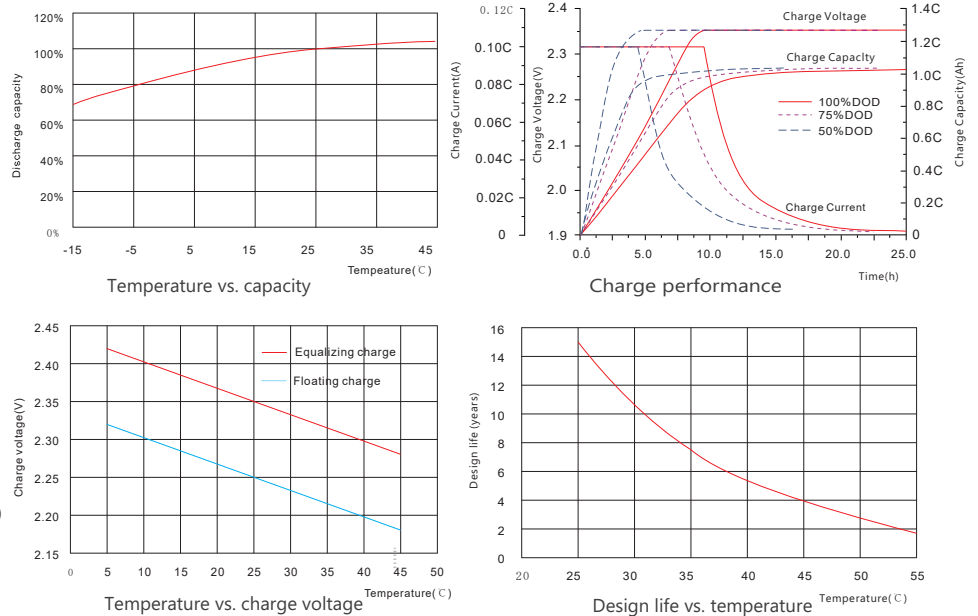

### Sacred Sun Power Sources Co., Ltd.

No.1 Shengyang Road Qufu City, PRC  
 sales@sacredsun.cn

### Sacred Sun Asia Pacific

No. 15, Yishun Industrial Street 1,  
 #01-17, WIN5, Singapore 768091  
 sales.asia@sacredsun.cn

### Sacred Sun Europe SPRL

Schoenstraat 96-9140 Temse, Belgium  
 sales.eu@sacredsun.cn

### Sacred Sun MEA FZE

S10122A1019 Jebel Ali, Dubai,  
 United Arab Emirates  
 sales.mea@sacredsun.cn

