

FMJ Series

6FMJ-85 12V85Ah

FMJ series gel batteries utilize advanced battery technology. FMJ has good cyclic performance and high reliability. It is the economical choice for solar photovoltaic street lights, garden and lawn lamps, traffic lights, warning lights and other energy storage systems.



Benefits

- Long life according to EUROBAT Classification
- High discharge performance
- High gas recombination efficiency
- Maximum charge efficiency
- GEL state electrolyte prevents leakage and layering
- Low resistance PVC or PF micro-porous separator ensure low self-discharge rate
- Easy installation and handling

Applications

- Telecommunications
- Emergency power
- Energy storage systems
- UPS units
- Electrical Power plants and substation

Standards

- IEC 60896-21/22
- IEC 61427
- DIN 43539-T5
- EUROBAT guide

Drawing

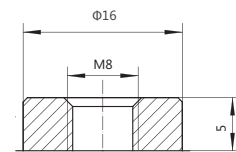
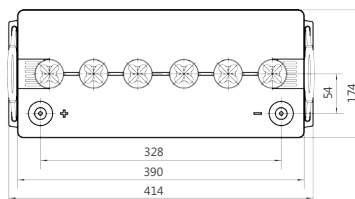
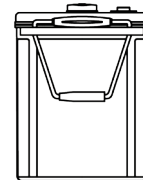
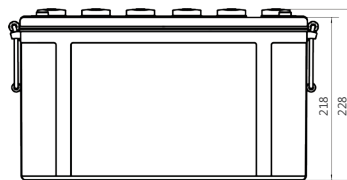

GFM-24

Specifications

Battery Model	6FMJ-85			
Design Life (years, 25°C)	15			
Capacity (Ah, 25°C)	10HR (8.5A, 1.80V)	5HR (14.45A, 1.80V)	3HR (21.25A, 1.80V)	1HR(45.76A, 1.80V)
	85	72.25	63.75	45.76
Dimensions (mm)	Length	Width	Height	Total Height
	414	174	218	228
Approx. Weight (kg)	34.0			
Reference Internal Resistance (mΩ)	5.19 (fully charged @ 25°C)			
Maximum Discharge Current (A/3 Sec.)	1012			
Self-Discharge (25°C)	< 2% per month			
Charge Voltage (V/cell, 25°C)	Cycle use		Float use	
	2.33 (-3.5mV/°C/cell), max charge current: 17A		2.22 (-3.5mV/°C/cell)	
Short Circuit Current (A)	2060			

Discharge Data

Constant Current Discharge Data (25°C, A)																		
End Voltage (V/cell)	min			h														
	15	30	45	1	1.5	2	3	4	5	6	8	10	20	24	48	100	120	240
1.60	133	84.96	59.30	50.12	38.17	29.80	23.26	18.62	15.83	14.42	11.17	9.308	4.794	4.046	2.015	0.969	0.927	0.485
1.65	129	83.26	58.11	49.11	37.41	29.21	22.80	18.24	15.50	14.14	10.95	9.121	4.692	3.970	1.972	0.961	0.918	0.476
1.70	125	81.60	56.95	48.14	36.66	28.65	22.31	17.88	15.20	13.86	10.73	8.934	4.599	3.893	1.947	0.952	0.910	0.468
1.75	121	79.97	55.73	47.18	35.92	28.05	21.86	17.53	14.88	13.57	10.51	8.755	4.514	3.817	1.913	0.944	0.901	0.459
1.80	115	77.56	54.14	45.76	34.85	27.21	21.25	17.00	14.45	13.18	10.20	8.500	4.420	3.740	1.887	0.935	0.893	0.451

Constant Power Discharge Data (25°C, W/cell)																		
End Voltage (V/cell)	min			h														
	15	30	45	1	1.5	2	3	4	5	6	8	10	20	24	48	100	120	240
1.60	231	149	104	88.20	67.17	52.45	41.63	33.88	28.96	26.24	20.55	17.31	9.204	7.849	3.948	1.928	1.853	0.979
1.65	226	147	103	87.42	66.96	52.28	41.49	33.56	28.68	26.15	20.36	17.24	9.102	7.780	3.905	1.921	1.845	0.966
1.70	222	146	102	86.64	66.36	52.13	41.06	33.07	28.42	26.05	20.27	17.15	9.013	7.747	3.874	1.914	1.837	0.954
1.75	219	146	101	85.86	66.09	51.89	40.66	32.78	28.11	25.93	20.19	17.07	8.892	7.633	3.825	1.906	1.829	0.941
1.80	214	143	100	85.11	65.52	51.70	40.38	32.47	27.89	25.69	19.99	16.83	8.840	7.517	3.793	1.898	1.821	0.928

Performance Curve

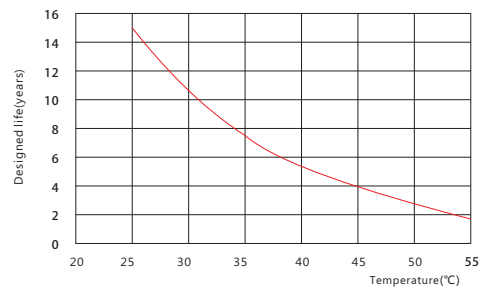
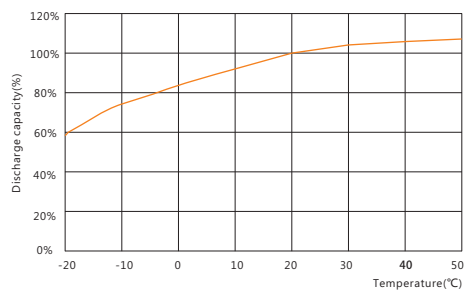
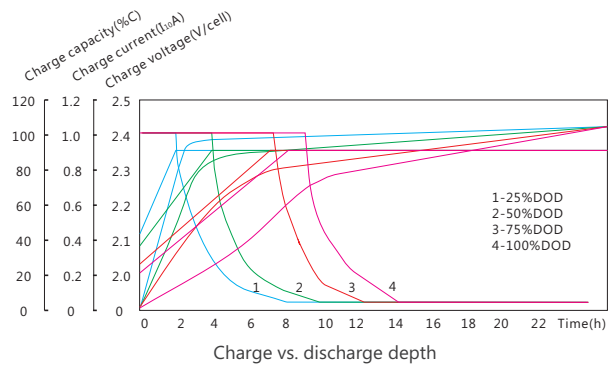
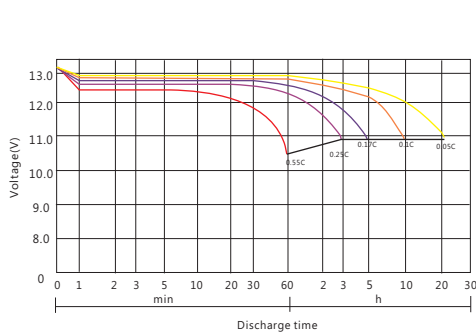

Sacred Sun Power Sources Co., Ltd.

Add: No.1 Shengyang Road, Qufu 273100 PRC
Tel: +86-537-4422313 Fax: +86-537-4411980
Email: sales@sacredsun.cn

Sacred Sun Hong Kong Co., Limited

Add: RM 19C Lockhart CTR 301-307 Lockhart RD Wan Chai, Hong Kong
Email: admin.hk@sacredsun.hk

Sacred Sun Asia Pacific Pte Ltd.

Add: 1 Ubi View, #04-12, Focus One, Singapore 408555
Email: admin.sg@sacredsun.sg

Sacred Sun Europe SARL

Add: ZAE Fontaine, 33210 Fargues, France
Email: admin.eu@sacredsun.eu

Sacred Sun MEA FZE

Add: No. 311 office, Building LOB 14, JAFZA, Dubai, UAE
Email: admin.ae@sacredsun.ae

