

HRL Series

HRL12-300W 12V70Ah



Sacred Sun HRL batteries adopt new appearance and constructure design, automatically welding+through the partition welding+heat sealing technolgy, full automatic production process with good consistency. It has excellent high power discharge, long floating backup time and fast charging performance. It can be widely used in data center, UPS, IDC room.

Benefits

- Very long life according to EUROBAT Classification
- High power density, 30% higher than ordinary batteries
- Special lead paste formual and additives improve the battery service life
- Maximum charge efficiency
- Low self-discharge rate
- Wide range of power, easy sizing of batteries
- Easy installation and handling

Applications

- Data center
- UPS
- IDC room
- Emergency power
- HVDC system

Standards

- IEC 60896-21/22
- JIS C8704-1/2
- EUROBAT guide

Drawing

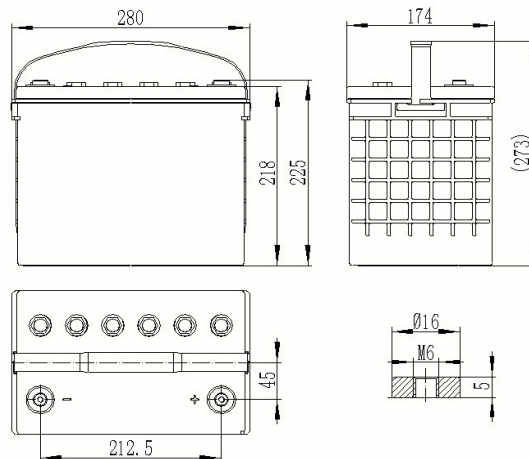

Specifications

Battery Model	HRL12-300W			
Design Life (years, 25°C)	15			
Capacity (Ah, 25°C)	10min (1.60V)	15min (1.67V)	1HR (45A, 1.70V)	10HR(7.0A, 1.80V)
	380	300	45	70
Dimensions (mm)	Length	Width	Height	Total Height
	280	174	218	225
Approx. Weight (kg)	25.4			
Reference Internal Resistance (mΩ)	3.4 (fully charged @ 25°C)			
Maximum Discharge Current (A/3 Sec.)	830			
Self-Discharge (25°C)	≤ 2% per month			
Charge Voltage (V/cell, 25°C)	Cycle use		Float use	
	2.35(-3.5mV/°C/cell), max charge current: 17.5A		2.25 (-3.5mV/°C/cell)	
Short Circuit Current (A)	2800			

Discharge Data

Constant Power Discharge Data (25°C, W/cell)																
End Voltage (V/cell)	min							h								
	5	10	15	20	25	30	45	1	1.5	2	3	4	5	6	8	10
1.60	530	380	316	250	210	188	133	93.0	75.3	59.6	43.0	33.7	28.0	24.4	19.2	15.8
1.65	480	370	307	243	204	185	130	91.0	74.0	58.8	42.4	33.3	27.7	24.2	19.0	15.6
1.67	470	360	300	238	200	180	127	89.0	72.8	58.2	42.0	32.8	27.5	23.8	18.8	15.4
1.70	460	352	290	230	194	175	124	87.0	71.4	57.3	41.4	32.5	27.0	23.5	18.5	15.2
1.75	440	336	260	213	180	170	116	82.3	68.0	55.3	40.0	31.4	26.3	22.8	17.8	14.7
1.80	410	320	240	193	164	150	106	76.3	64.0	53.0	38.4	30.0	25.2	21.8	17.2	14.0

Constant Current Discharge Data (25°C, A)																
End Voltage (V/cell)	min							h								
	5	10	15	20	25	30	45	1	1.5	2	3	4	5	6	8	10
1.60	310	230	177	138	113	96.0	69.8	48.6	39.0	30.8	22.2	17.4	14.4	12.5	9.8	8.0
1.65	290	222	170	133	110	93.6	68.0	47.4	38.2	30.3	21.8	17.0	14.2	12.3	9.6	7.9
1.67	280	215	166	130	107	91.7	66.4	46.4	37.5	29.8	21.5	16.8	14.0	12.0	9.5	7.8
1.70	265	206	160	125	104	89.0	64.3	45.0	36.6	29.3	21.0	16.5	13.8	11.8	9.3	7.7
1.75	240	185	145	114	95.2	85.3	59.5	42.0	34.6	28.0	20.3	15.8	13.2	11.5	9.0	7.4
1.80	220	170	128	102	85.4	75.5	53.8	38.5	32.2	26.6	19.3	15.0	12.6	10.8	8.5	7.0

Performance Curve

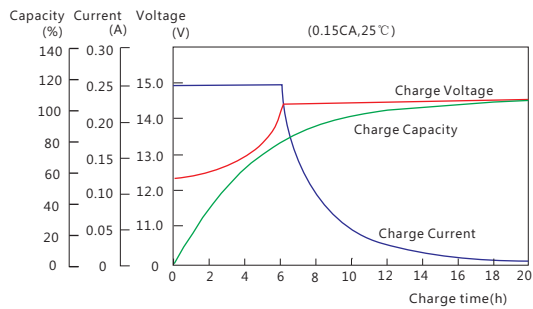

Charge performance

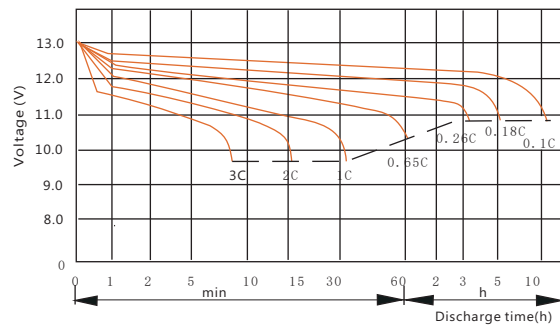

Discharge voltage vs. discharge time

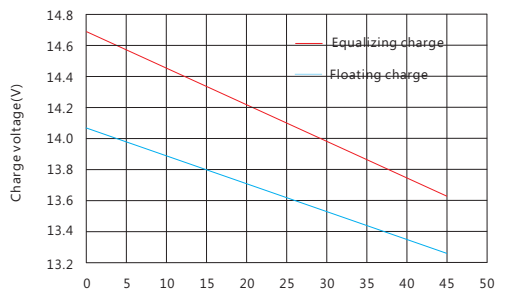

Temperature vs. charge voltage

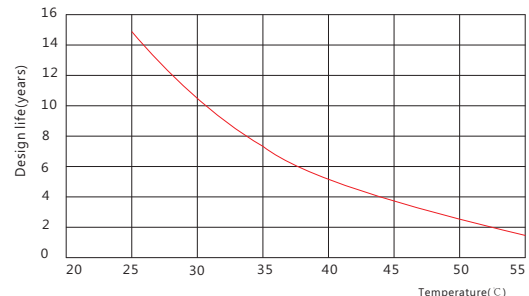

Design life vs. temperature

Sacred Sun Power Sources Co., Ltd.

Add: No.1 Shengyang Road, Qufu 273100 PRC
 Tel: +86-537-4422313 Fax: +86-537-4411980
 Email: sales@sacredsun.cn

Sacred Sun Hong Kong Co., Limited

Add: RM 19C Lockhart CTR 301-307 Lockhart RD Wan Chai, Hong Kong
 Email: admin.hk@sacredsun.hk

Sacred Sun Asia Pacific Pte Ltd.

Add: 1 Ubi View, #04-12, Focus One, Singapore 408555
 Email: admin.sg@sacredsun.sg

Sacred Sun Europe SARL

Add: ZAE Fontaine, 33210 Fargues, France
 Email: admin.eu@sacredsun.eu

Sacred Sun MEA FZE

Add: No. 311 office, Building LOB 14, JAFZA, Dubai, UAE
 Email: admin.ae@sacredsun.ae

